



MODEL KTM RC 125

YEAR 2014-2016

LINE FULL SYSYTEM

MUFFLER GP

SCHEMATIC

ELENCO PARTI / PARTS LIST

#	QTÀ / QTY	DESCRIZIONE / DESCRIPTION	CODICE / CODE
1	1	DB killer / DB killer	50.DK.020.0
2	1	Silenziatore / Muffler	GP
3	1	Protezione in gomma per staffa / Rubber protection for bracket	50.73.077.1
4	1	Staffa / Bracket	50.SS.241.1
5	2	Vite M6 x 12 / Screw M6 x 12	50.72.024.1
6	4	Rondella M6 / Washer M6	50.72.027.1
7	2	Dado M6 autobloccante / M6 locknut	50.73.112.1
8	2	Vite M8x40 / Screw M8x40	50.73.075.1
9	1	Rondella in alluminio / Aluminium washer	50.73.063.1
10	1	Distanziale in alluminio / Aluminium spacer (Øe.30 Øi.8,5 h.20)	50.SS.056.1
11	1	Staffa / Bracket	50.SS.876.0
12	3	Dado M8 flangiato / Flanged nut M8	50.73.393.1
13	1	Tubo di raccordo / Link pipe	9773KT016S7B
14	1	Silenziatore / Muffler	9873KT009S2A
15	1	Tubo di raccordo / Link pipe	9773KT009S7A
16	1	Vite M8x16 / Screw M8x16	50.73.006.1
17	1	Guarnizione in grafite / Graphite bush	50.72.38.44.28
18	1	Fascetta Ø 44/47 mm / Pipe clamp Ø 44/47 mm	50.FA.006.1
19	1	Distanziale alluminio / Aluminium spacer (Øe.20 Øi.8,5 h.14)	50.SS.058.1
20	1	Rondella in alluminio / Aluminium washer	50.73.248.1
21	1	Molla lunga / Long spring	50.71.080.1
22	1	Tubo in gomma per molla / Rubber pipe for spring	50.73.210.1
23	2	Vite M5x30 / Screw M5x30	50.73.472.1
24	1	Copertura in alluminio / Aluminium cover	50.CR.022.0
25	2	Distanziale in alluminio / Aluminium spacer (Øe.10 Øi.6 h.8)	50.73.759.1
26	2	Rondella M5 / Washer M5	50.73.351.1
27	2	Dado M5 / M5 nut	50.73.267.1

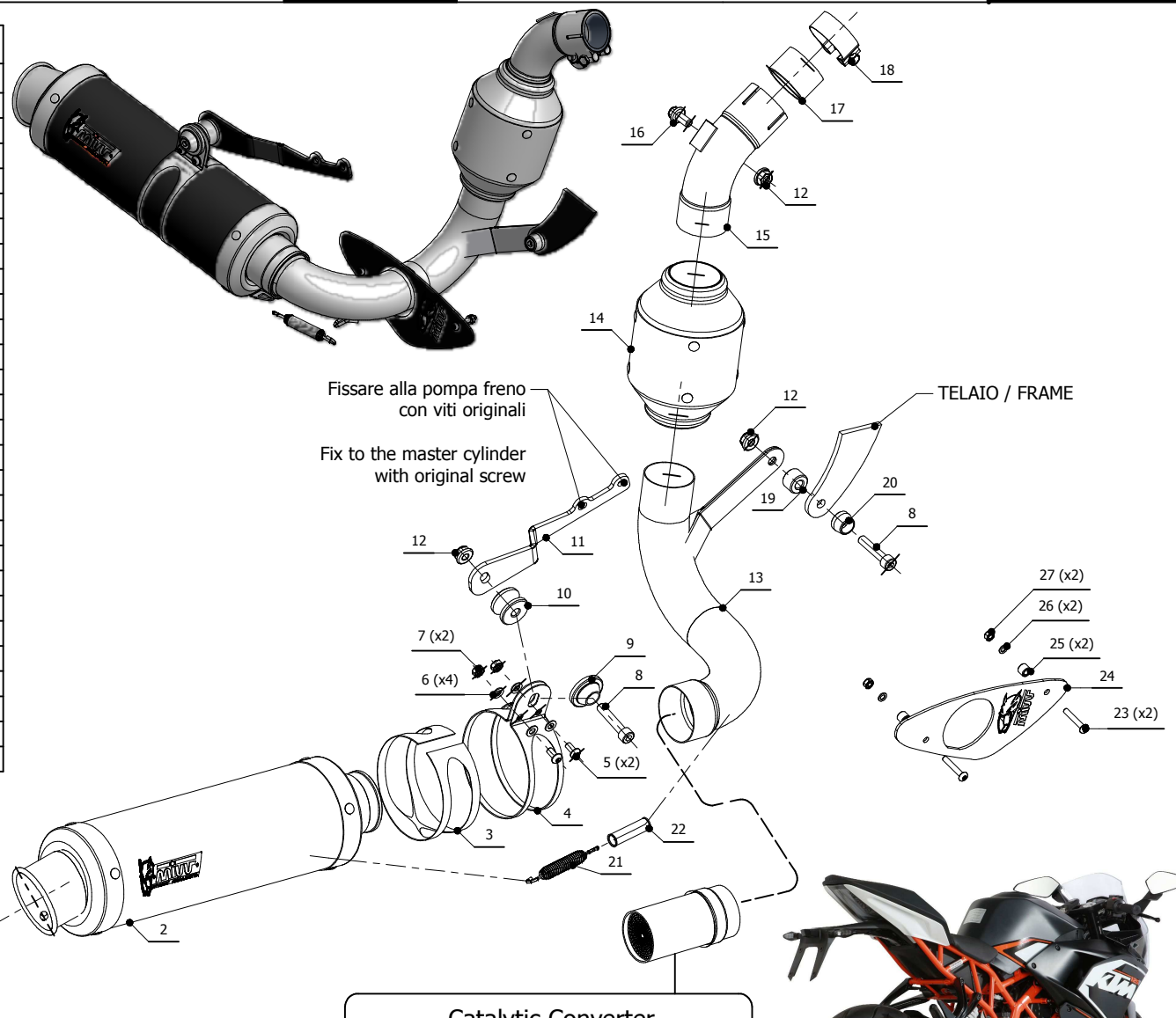

Catalytic Converter
Cod. ACC.033.A1
Optional for KT.016.L2S - KT.016.L6S - KT.016.LXB
Included in KT.016.K2S - KT.016.K6S - KT.016.KXB



APPLICAZIONI / APPLICATIONS

CODICE / CODE	SILENZIATORE / MUFFLER	TUBO / PIPE	FASCETTA / CLAMP	NOTE
KT.016.L2S KT.016.L6S KT.016.LXB	CARBONIO / CARBON FIBER TITANIO / TITANIUM STEEL BLACK	INOX / ST. STEEL	INOX / ST. STEEL	CATALYTIC CONVERTER NOT INCLUDED
KT.016.K2S KT.016.K6S KT.016.KXB	CARBONIO / CARBON FIBER TITANIO / TITANIUM STEEL BLACK	INOX / ST. STEEL	INOX / ST. STEEL	CATALYTIC CONVERTER INCLUDED